

VITA ADIVA® FULL-ADHESIVE LUTING



1. Tooth Conditioning

2. Restoration Conditioning

3. Luting

Workflow for full-adhesive luting of zirconia crowns
 Workflow für volladhäsive Befestigung von Zirkondioxid-Kronen

1 2

3 4

5 6

1. Tooth Conditioning
 Konditionierung Zahn

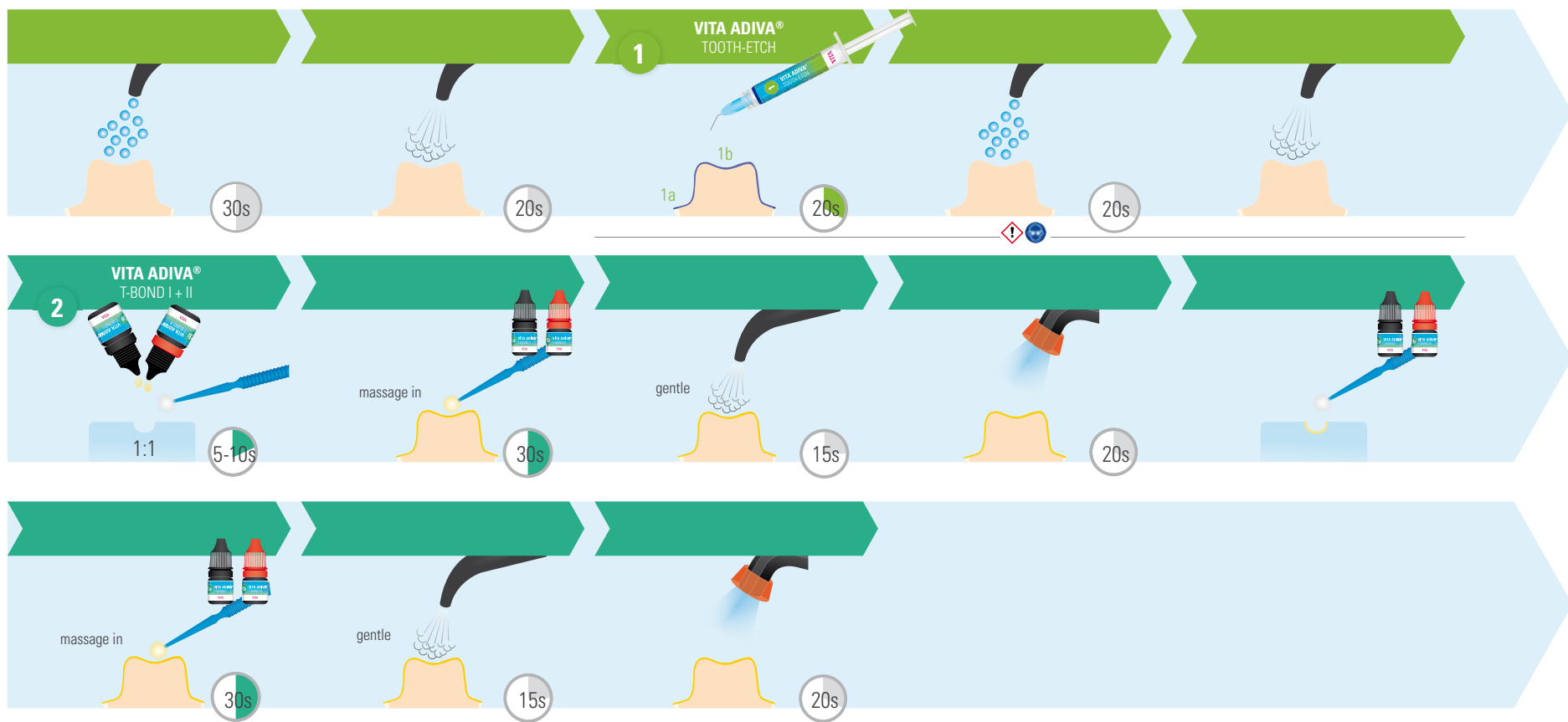

For „Restoration Conditioning“/ „Luting“ please turn over!
 Für „Konditionierung Restauration“/ „Befestigung“ bitte wenden!

VITA ADIVA® FULL-ADHESIVE LUTING



1. Tooth Conditioning

2. Restoration Conditioning

3. Luting

Workflow for full-adhesive luting of zirconia crowns
 Workflow für volladhäsive Befestigung von Zirkondioxid-Kronen

1 2

3 4

5 6

2. Restoration Conditioning /
 Konditionierung Restauration

3. Luting /
 Befestigung

3 **VITA ADIVA® CERA-ETCH**

No!

Al₂O₃
50 µm/2 bar

4 **VITA ADIVA® ZR-PRIME**

gentle

10s

5 **VITA ADIVA® F-CEM**

6 **VITA ADIVA® OXY-PREVENT**

Light-curing
Lichthärtung

each side
jede Seite

20s