



# PERFECT MATCH.

# VITA

VITA MEDIA DATABASE  
User Manual

<https://mam.vita-zahnfabrik.com>

# Log-in

# VITA



**VITA** Media database

User (E-mail)

Password

Login

[Password forgotten](#)

[Register as new user](#)

 English ▾

Log in with the familiar VITA login credentials:

VITA ID for VITA employees or e-mail address and password.

If you would like to use the media database and are not yet logged in, you can register here.

Changing the language in German, French, Italian or Spanish is possible here.

# Media search. Symbols

# VITA

VITA Media database

Type of media objects Search

20 of 11526 results

VITA AKZENT Plus CHROMA STAINS ZIP

SD321 VITA AMBRIA ZIP

VITA LUMEX AC ZIP

V 005 10375 DE EN IT ES PL

V 005 DE EN FR IT ES ...

V 003 10609 DE EN FR IT ES ...

Language icons indicate the languages in which the asset is available.

To download the asset in a specific language, click or double-click. The detailed view opens. See detailed view.

Displays the file format.

All brochures are available as a ZIP, as PDFs in several languages are included.

V 003 indicates which version is involved.

10609 indicates the print number.

# Media search. Filter



VITA Media database

Contact & support Change password English

Type of media objects Search

Add to collection

Filter

- Product communication
  - Offer sheets and sales info
  - Application pictures
  - User manuals
  - Instructions for use
  - Order blocks
  - Firing tables
  - Brochures
  - CAD drawings
  - Spare part lists
  - Press

Search Reset

20 of 11526 results

VITAVM.LC  
Ebrauchsanleitung/Vollversion VITA VM LC und VITA VM LC f/bw

VITA VIONIC® SOLUTIONS

SD027 VITA VM CC LIQUID

This "filter search" can be used to filter according to predefined categories, such as product and publication type (brochure, instructions for use).

The filter selection is started via "Search" and can be cleaned via "Reset".

# Media search

VITA

Here you can search for media objects using full text search / keywords / print numbers.

It can be combined with the filter of the categories and the type of media objects.

This menu allows you to select the **media types**, e.g. image, document or video.

Type of media objects

Search for media objects...

Filter for media objects

- >  Image
- >  Documents
- >  Artwork
- >  Video

VITA Media database

Contact & support Change password English Logout

Add to collection My collections

Gallery List All New

Type of media objects

Filter

- >  Categories
- >  Types of publication
- >  Languages
- >  Derivatives
- >  Status

Search Reset

Search

Vitablo

- vitabloc
- vitabloc2
- vitablocneutral
- vitablocs
- vitablocneutral

VITA - perfect match. VITA

VITA VM LC

VITA VIONIC SOLUTIONS

SD027 VITA VM CC LIQUID

V 012 1200 DE

V 003 10668M DE EN FR IT ES

V 006 DE EN FR IT ES ...

# Media search. TIP

VITA

The screenshot shows the VITA Media database search interface. At the top left, the VITA logo and 'Media database' are displayed. On the right, there are links for 'Contact & support', 'Change password', and 'English'. A search bar contains the text 'Picture from 10805'. Below the search bar, a dropdown menu lists search suggestions: 'picture', 'pictures', 'from', '10805', and '108050'. A red information icon (i) is positioned to the left of a white tip box. The tip box contains the following text: 'TIP for the image search: Search for images using the search term "Picture from" and the print number of the brochure, e.g. 10805: Picture from 10805 Confirm with Return. All images in the brochure – if available – will be displayed.' The background shows a grid of search results, including images of dental products like Vita VMW and Vita VMWc, with a 'PSD' button overlaid on each.

VITA Media database

Contact & support Change password English

Type of media objects

Search

Picture from 10805

picture

pictures

from

10805

108050

**i**

**TIP for the image search:**

Search for images using the search term "Picture from" and the print number of the brochure, e.g. 10805: Picture from 10805  
Confirm with Return.

All images in the brochure – if available – will be displayed.

20 of 27 results

PSD

Gallery List

PSD

# Media selection and activities



Select this asset for download or to add to a collection. Multiple assets can be selected in the gallery.

Direct download of the original file.

Directly add the file to a collection.

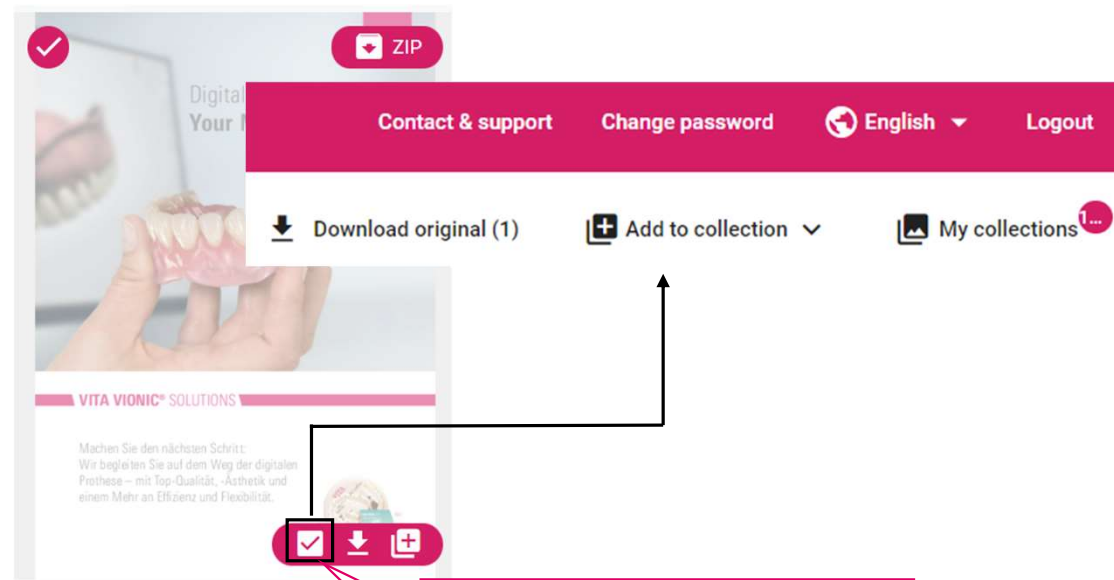

If the "selection checkmark" is set in the window, the options for downloading the (original) file, as well as for adding the original to a collection, appear again in the upper right corner.



# Collection selection

1

All available collections are displayed here. You can select which collection the file is to be added to.

2

Alternatively, a new collection can be created here, which is then available for collection selection.

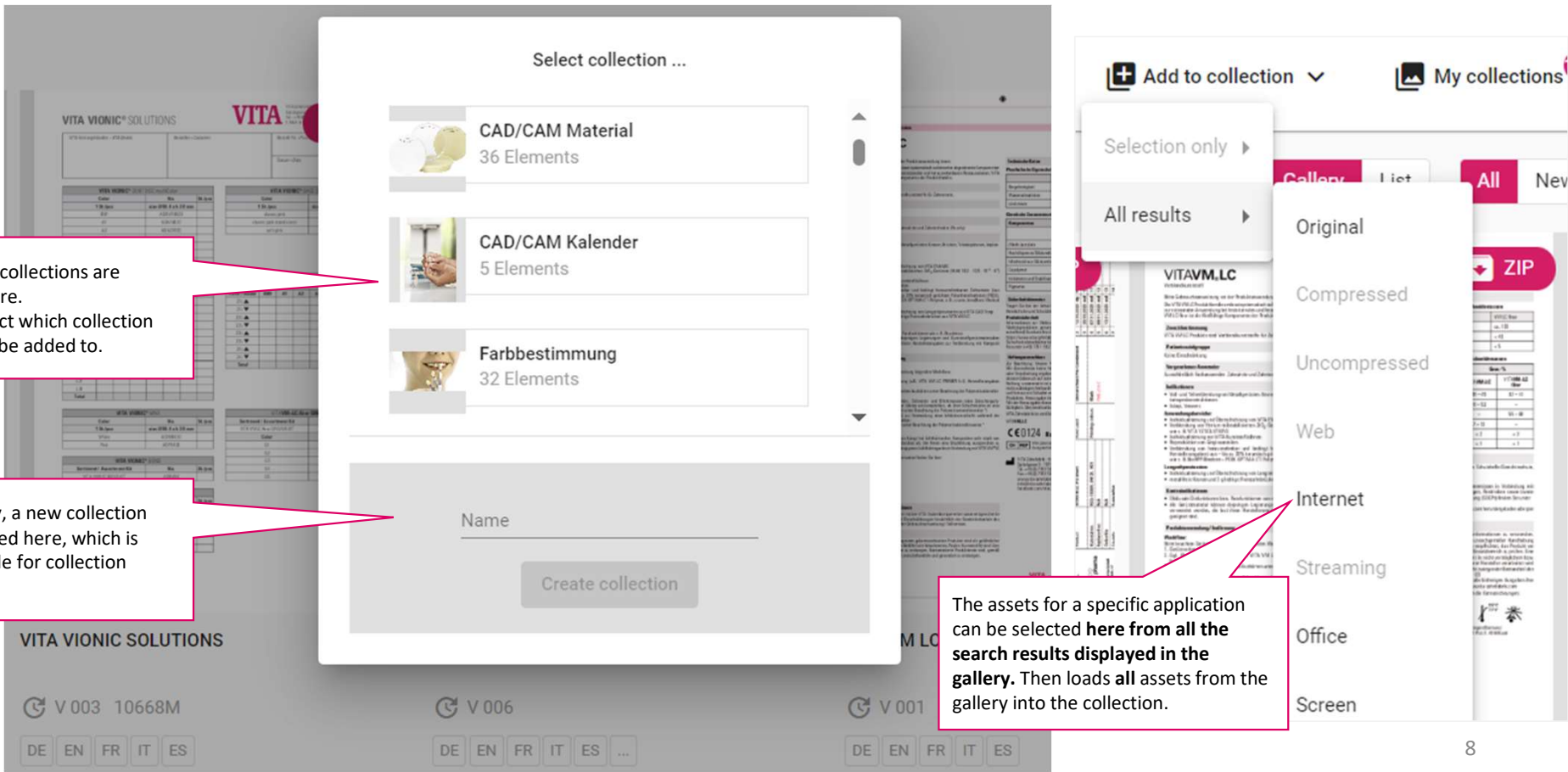

The assets for a specific application can be selected here from all the search results displayed in the gallery. Then loads all assets from the gallery into the collection.



# Media information. Detailed view

VITA

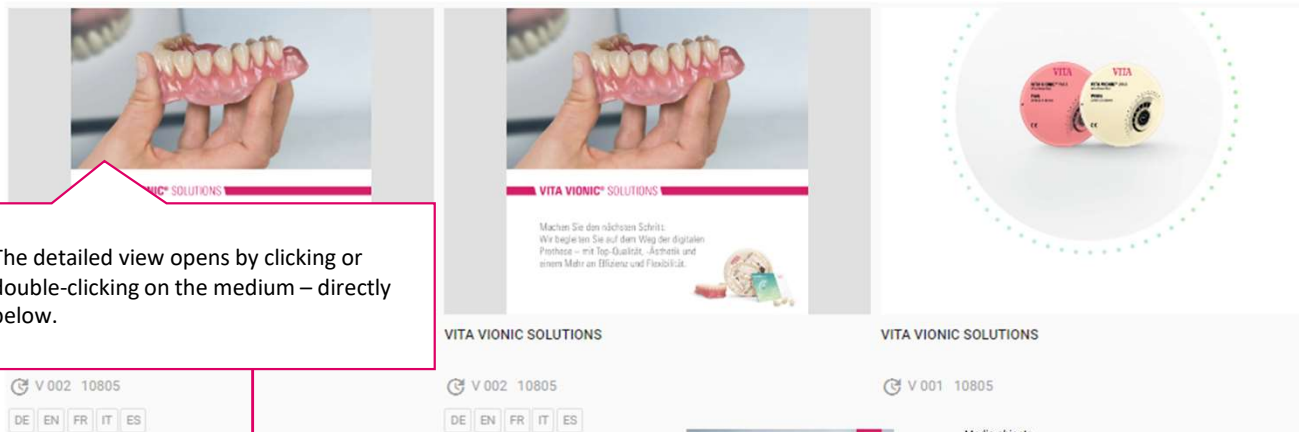

The detailed view opens by clicking or double-clicking on the medium – directly below.

Media objects
<input type="checkbox"/> 10805_VITA-VL... MA-123... Original
<input checked="" type="checkbox"/> 10805D_VITA_... MO-126... Screen
<input type="checkbox"/> 10805E_VITA_... MO-126... Screen
<input type="checkbox"/> 10805F_VITA_... MO-126... Screen
<input type="checkbox"/> 10805L_VITA_... MO-126... Screen
<input type="checkbox"/> 10805SP_VITA_... MO-126... Screen

VITA VIONIC SOLUTIONS  
V 002 10805  
DE EN FR IT ES MA-123178  
Created on 30/10/2023  
Categories Products > Removable prosthetics > Digital prosthetics > VITA VIONIC®

Languages and other file formats can be selected in the detailed view for the desired use.

Further information on the medium, such as category, author or print number, can also be viewed.

Linked assets such as images or other PDFs are displayed below the categories by clicking on "Search relatives".  
"Search other versions" shows the versions created so far.

Categories  
Categories ▶ Products ▶ Removable prosthetics ▶ Digital prosthetics ▶ VITA VIONIC®  
Categories ▶ Products ▶ Removable prosthetics ▶ Digital prosthetics ▶ VITA VIONIC® BASE DISC HI  
Categories ▶ Products ▶ Removable prosthetics ▶ Digital prosthetics ▶ VITA VIONIC® BOND  
Categories ▶ Products ▶ Removable prosthetics ▶ Digital prosthetics ▶ VITA VIONIC® DENT DISC  
Categories ▶ Products ▶ Removable prosthetics ▶ Digital prosthetics ▶ VITA VIONIC® DIGITAL VIGO Denture Tooth Library  
Categories ▶ Products ▶ Removable prosthetics ▶ Digital prosthetics ▶ VITA VIONIC® WAX

Types of publication ▶ Product communication ▶ Brochures

Source ▶ DOTS  
Source ▶ Printer Schmerbeck

Status  
Free internal+external

SAP print number  
10805

Owner  
Gatz, Julia

Originator  
Layout: DOTS Satz: Druckerei Schmerbeck

Disclaimer ▼

Search relatives Search other versions

# Media information. Detailed view

VITA



## VITA VIONIC® SOLUTIONS

Machen Sie den nächsten Schritt:  
Wir begleiten Sie auf dem Weg der digitalen  
Prothese – mit Top-Qualität, -Ästhetik und  
einem Mehr an Effizienz und Flexibilität.



VITA VIONIC SOLUTIONS

V 002

## Media objects

<input type="checkbox"/>	10805_VITA-VI...	MA-123...	Original	▼
<input checked="" type="checkbox"/>	10805D_VITA_...	MO-126...	Screen	👁
<b>Name</b>		10805D_VITA_VIONIC_SOLUTIONS_VK_DE_V02_screen.pdf		
<b>Number</b>		MO-126488		
<b>Languages</b>		de		
<b>Filesize</b>		2,79 MB		
<b>View PDF</b>		👁		
<input type="checkbox"/>	10805E_VITA_...	MO-126...	Screen	👁
<input type="checkbox"/>	10805F_VITA_...	MO-126...	Screen	👁 ▼
<input type="checkbox"/>	10805I_VITA_...	MO-126...	Screen	👁 ▼
<input type="checkbox"/>	10805SP_VITA...	MO-126...	Screen	👁 ▼

Shows the usage. Here is a screen PDF for viewing, not for printing.

The individual file formats are displayed here in the respective languages of the medium.

If the file is a PDF, it can be opened directly in the media database with the Document Viewer via the eye.

The selected file formats can be added to the collection here.

Download

Add to collection

# My collections

1

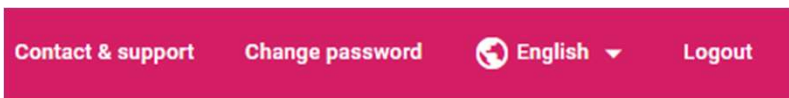

×

+ Add to collection ▾

My collections 1...

The saved collections can be managed via "My collections".

The number at the top right shows the number of all media objects in all collections. If a media object is added or removed, the number changes accordingly.

2

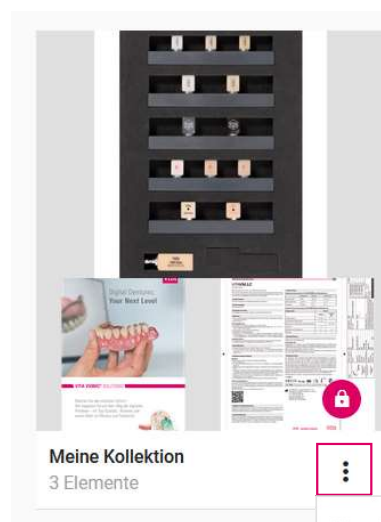

Each user already has a collection available at the beginning. This can neither be renamed nor deleted.

Empty collection

Delete collection

Collections can be emptied or deleted here.

3

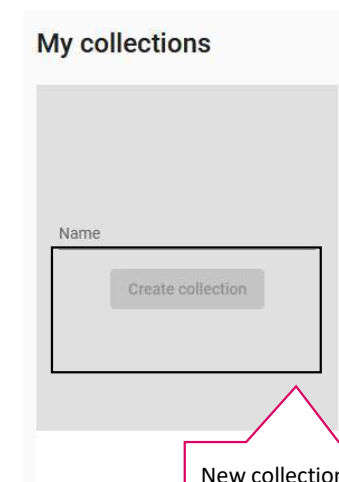

New collections can be created here.

# My collections. Detailed view

**1** Collections can be renamed using this icon.

**2** Clicking on the collection opens it. Here you can download all media objects contained in it, update or share the collection.

Contact & support   Change password   English   Logout

Download all   Refresh   Share collection

Gallery   List   Obtainable (5)   Approval required (0)

My collections / Test Kollektion 

5 Elements



**3** Individual media objects can also be selected, downloaded or deleted here.

# Postprocessing a collection

**i Use Case:** only selected media objects from a collection are to be downloaded or deleted.

2 The selected / marked media objects can be downloaded or removed from collection here.

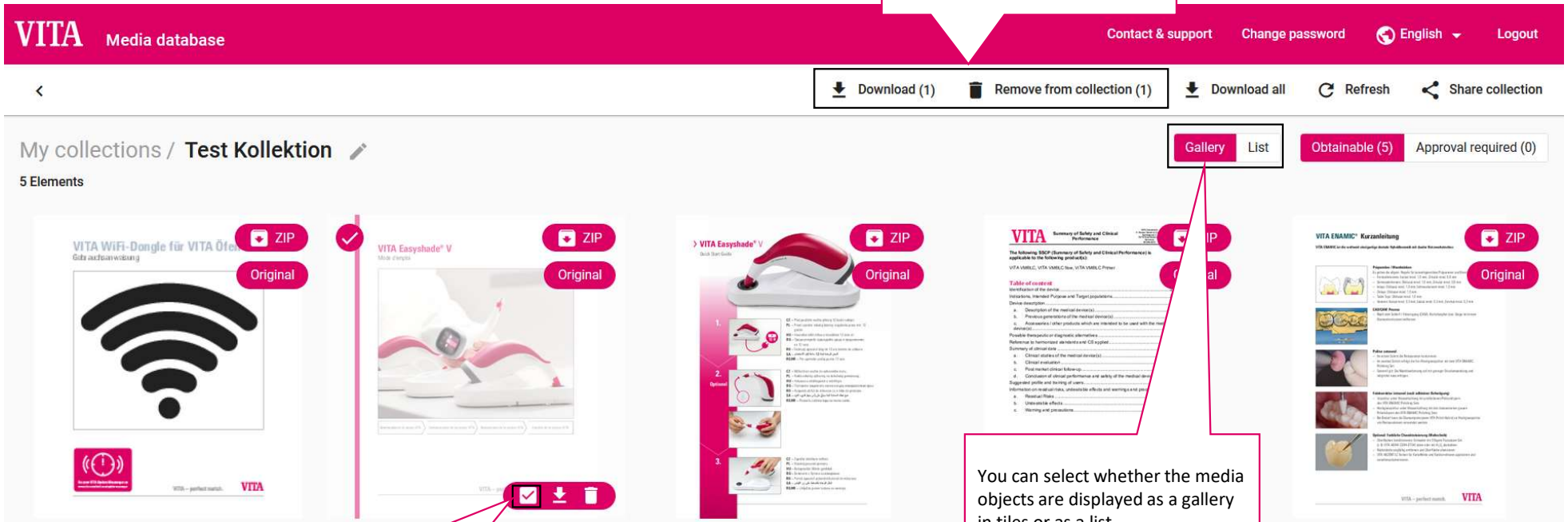

1 The desired media objects can be selected here (multiple selection possible).

You can select whether the media objects are displayed as a gallery in tiles or as a list.

# Share collections

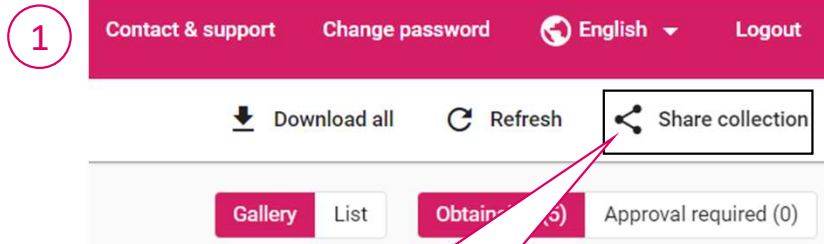

Within a collection, a click on "Share collection" opens the adjacent mask.

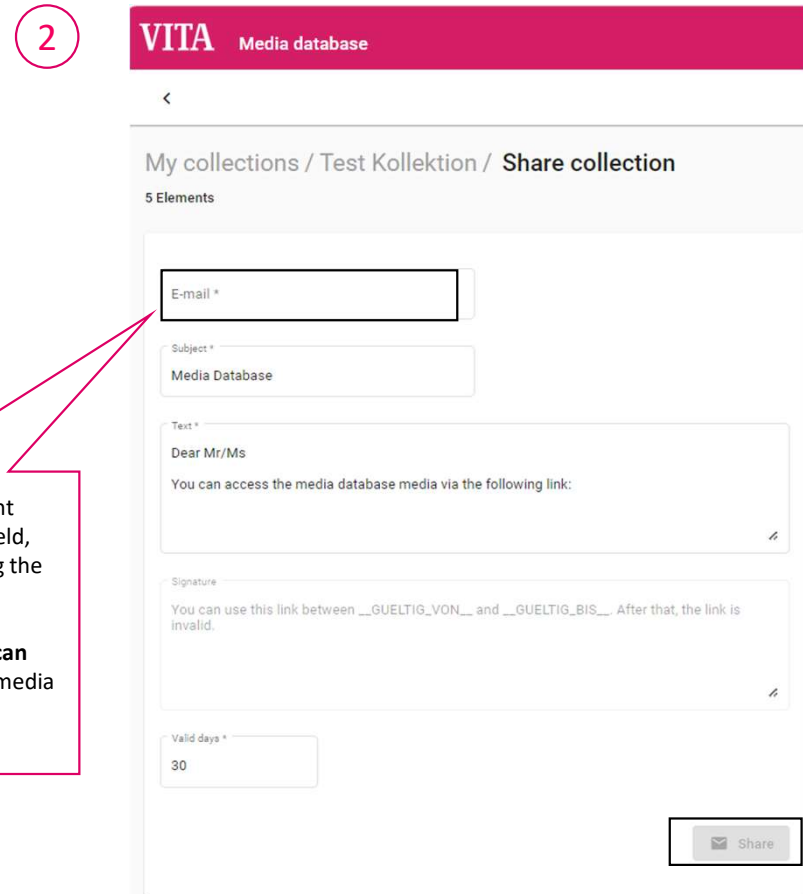

After filling in the desired recipient email address, subject and text field, the collection can be shared using the lower right button "Share".

A link will be sent. **The recipient can open the link** and download the media **without logging in** to the media database.

# Open Document Viewer

 **Attention:** The Document Viewer can only be used for PDF files. Therefore, select the detailed view for brochures that are in ZIP format (as other languages are included). The "eye" symbol appears there for viewing in the Document Viewer.

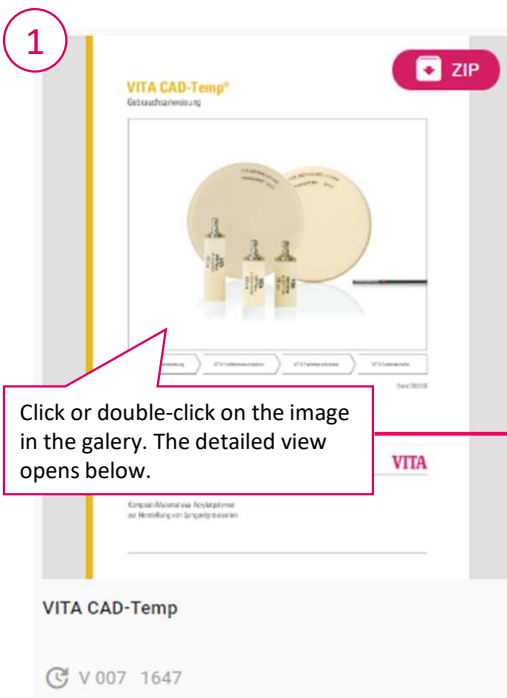

Click or double-click on the image in the gallery. The detailed view opens below.

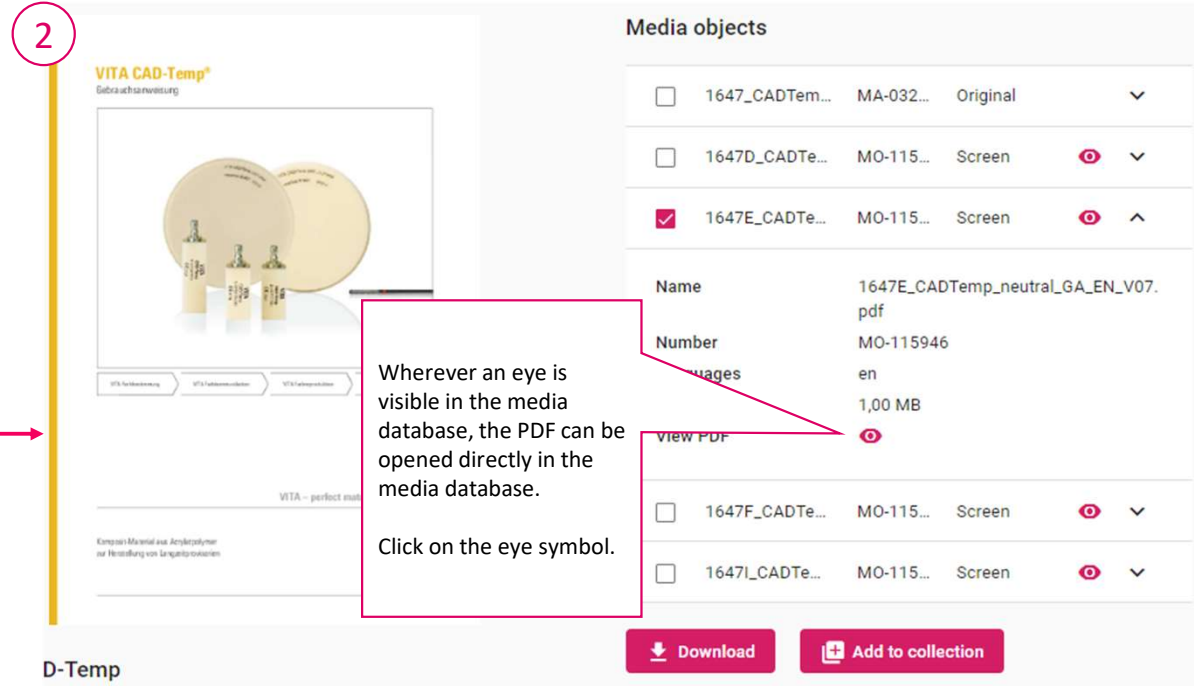

Wherever an eye is visible in the media database, the PDF can be opened directly in the media database.

Click on the eye symbol.



# Document Viewer Properties 1

VITA Media database Contact & support Change password English Logout

112% [-] [0] [1] [2] [3] [4] [5] [6] [7] [8] [9] [10] [11] [12] [13] [14] [15] [16] [17] [18] [19] [20] [21] [22] [23] [24] [25] [26] [27] [28] [29] [30] [31] [32] [33] [34] [35] [36] [37] [38] [39] [40] [41] [42] [43] [44] [45] [46] [47] [48] [49] [50] [51] [52] [53] [54] [55] [56] [57] [58] [59] [60] [61] [62] [63] [64] [65] [66] [67] [68] [69] [70] [71] [72] [73] [74] [75] [76] [77] [78] [79] [80] [81] [82] [83] [84] [85] [86] [87] [88] [89] [90] [91] [92] [93] [94] [95] [96] [97] [98] [99] [100] [101] [102] [103] [104] [105] [106] [107] [108] [109] [110] [111] [112] [113] [114] [115] [116] [117] [118] [119] [120] [121] [122] [123] [124] [125] [126] [127] [128] [129] [130] [131] [132] [133] [134] [135] [136] [137] [138] [139] [140] [141] [142] [143] [144] [145] [146] [147] [148] [149] [150] [151] [152] [153] [154] [155] [156] [157] [158] [159] [160] [161] [162] [163] [164] [165] [166] [167] [168] [169] [170] [171] [172] [173] [174] [175] [176] [177] [178] [179] [180] [181] [182] [183] [184] [185] [186] [187] [188] [189] [190] [191] [192] [193] [194] [195] [196] [197] [198] [199] [200] [201] [202] [203] [204] [205] [206] [207] [208] [209] [210] [211] [212] [213] [214] [215] [216] [217] [218] [219] [220] [221] [222] [223] [224] [225] [226] [227] [228] [229] [230] [231] [232] [233] [234] [235] [236] [237] [238] [239] [240] [241] [242] [243] [244] [245] [246] [247] [248] [249] [250] [251] [252] [253] [254] [255] [256] [257] [258] [259] [260] [261] [262] [263] [264] [265] [266] [267] [268] [269] [270] [271] [272] [273] [274] [275] [276] [277] [278] [279] [280] [281] [282] [283] [284] [285] [286] [287] [288] [289] [290] [291] [292] [293] [294] [295] [296] [297] [298] [299] [300] [301] [302] [303] [304] [305] [306] [307] [308] [309] [310] [311] [312] [313] [314] [315] [316] [317] [318] [319] [320] [321] [322] [323] [324] [325] [326] [327] [328] [329] [330] [331] [332] [333] [334] [335] [336] [337] [338] [339] [340] [341] [342] [343] [344] [345] [346] [347] [348] [349] [350] [351] [352] [353] [354] [355] [356] [357] [358] [359] [360] [361] [362] [363] [364] [365] [366] [367] [368] [369] [370] [371] [372] [373] [374] [375] [376] [377] [378] [379] [380] [381] [382] [383] [384] [385] [386] [387] [388] [389] [390] [391] [392] [393] [394] [395] [396] [397] [398] [399] [400] [401] [402] [403] [404] [405] [406] [407] [408] [409] [410] [411] [412] [413] [414] [415] [416] [417] [418] [419] [420] [421] [422] [423] [424] [425] [426] [427] [428] [429] [430] [431] [432] [433] [434] [435] [436] [437] [438] [439] [440] [441] [442] [443] [444] [445] [446] [447] [448] [449] [450] [451] [452] [453] [454] [455] [456] [457] [458] [459] [460] [461] [462] [463] [464] [465] [466] [467] [468] [469] [470] [471] [472] [473] [474] [475] [476] [477] [478] [479] [480] [481] [482] [483] [484] [485] [486] [487] [488] [489] [490] [491] [492] [493] [494] [495] [496] [497] [498] [499] [500] [501] [502] [503] [504] [505] [506] [507] [508] [509] [510] [511] [512] [513] [514] [515] [516] [517] [518] [519] [520] [521] [522] [523] [524] [525] [526] [527] [528] [529] [530] [531] [532] [533] [534] [535] [536] [537] [538] [539] [540] [541] [542] [543] [544] [545] [546] [547] [548] [549] [550] [551] [552] [553] [554] [555] [556] [557] [558] [559] [560] [561] [562] [563] [564] [565] [566] [567] [568] [569] [570] [571] [572] [573] [574] [575] [576] [577] [578] [579] [580] [581] [582] [583] [584] [585] [586] [587] [588] [589] [590] [591] [592] [593] [594] [595] [596] [597] [598] [599] [600] [601] [602] [603] [604] [605] [606] [607] [608] [609] [610] [611] [612] [613] [614] [615] [616] [617] [618] [619] [620] [621] [622] [623] [624] [625] [626] [627] [628] [629] [630] [631] [632] [633] [634] [635] [636] [637] [638] [639] [640] [641] [642] [643] [644] [645] [646] [647] [648] [649] [650] [651] [652] [653] [654] [655] [656] [657] [658] [659] [660] [661] [662] [663] [664] [665] [666] [667] [668] [669] [670] [671] [672] [673] [674] [675] [676] [677] [678] [679] [680] [681] [682] [683] [684] [685] [686] [687] [688] [689] [690] [691] [692] [693] [694] [695] [696] [697] [698] [699] [700] [701] [702] [703] [704] [705] [706] [707] [708] [709] [710] [711] [712] [713] [714] [715] [716] [717] [718] [719] [720] [721] [722] [723] [724] [725] [726] [727] [728] [729] [730] [731] [732] [733] [734] [735] [736] [737] [738] [739] [740] [741] [742] [743] [744] [745] [746] [747] [748] [749] [750] [751] [752] [753] [754] [755] [756] [757] [758] [759] [760] [761] [762] [763] [764] [765] [766] [767] [768] [769] [770] [771] [772] [773] [774] [775] [776] [777] [778] [779] [780] [781] [782] [783] [784] [785] [786] [787] [788] [789] [790] [791] [792] [793] [794] [795] [796] [797] [798] [799] [800] [801] [802] [803] [804] [805] [806] [807] [808] [809] [810] [811] [812] [813] [814] [815] [816] [817] [818] [819] [820] [821] [822] [823] [824] [825] [826] [827] [828] [829] [830] [831] [832] [833] [834] [835] [836] [837] [838] [839] [840] [841] [842] [843] [844] [845] [846] [847] [848] [849] [850] [851] [852] [853] [854] [855] [856] [857] [858] [859] [860] [861] [862] [863] [864] [865] [866] [867] [868] [869] [870] [871] [872] [873] [874] [875] [876] [877] [878] [879] [880] [881] [882] [883] [884] [885] [886] [887] [888] [889] [890] [891] [892] [893] [894] [895] [896] [897] [898] [899] [900] [901] [902] [903] [904] [905] [906] [907] [908] [909] [910] [911] [912] [913] [914] [915] [916] [917] [918] [919] [920] [921] [922] [923] [924] [925] [926] [927] [928] [929] [930] [931] [932] [933] [934] [935] [936] [937] [938] [939] [940] [941] [942] [943] [944] [945] [946] [947] [948] [949] [950] [951] [952] [953] [954] [955] [956] [957] [958] [959] [960] [961] [962] [963] [964] [965] [966] [967] [968] [969] [970] [971] [972] [973] [974] [975] [976] [977] [978] [979] [980] [981] [982] [983] [984] [985] [986] [987] [988] [989] [990] [991] [992] [993] [994] [995] [996] [997] [998] [999] [1000]

**THE SHADE CONCEPT**  
Materials with a single color (monoColor) or four color layers (multiColor) are available.

	1M1T*	1M2T	2M2T	3M2T
CAD-Temp monoColor				
CAD-Temp multiColor				

\* For the reproduction of bleached teeth only possible in size C1-40

**Preparation guidelines**  
Since VITA CAD Temp restorations normally provide the basis for definitive all ceramic restorations, the standard guidelines for the preparation of all ceramic restorations must be observed. For detailed information, see the brochure "Clinical Aspects of All Ceramic Crowns".

**Benefits**

- The material is suitable for restorations with a clinical wearing period of up to three years.\*
- Homogeneous material due to innovative manufacturing process
- Well balanced combination of mechanical properties such as tensile strength and elasticity, for clinical use and the specific indication.
- Excellent abrasion resistance (see literature).
- Translucency and fluorescence based on natural dentition.
- Biodeposque
- Good polishing characteristics.
- Can be individualized with the light curing VITA VM LC and VITA VM LC flow microparticle composite.
- Can be characterized with shades using VITA AKZ/NT LC

**Functions of temporary restorations made from VITA CAD-Temp**

- Prophylactic functions:**
  - avoiding the movement of abutment teeth
  - protecting the tooth substance against bacterial, toxic and thermal effects
- Diagnostic and esthetic functions:**
  - checking occlusion
  - checking phonetics
  - checking the vertical dimension
  - checking the esthetic result
- Therapeutic functions:**
  - gingival forming for controlled papillary growth for later implementation in all ceramic restorations
  - restoring implants during the healing phase
  - correction of temporomandibular joint disorders
  - correction of the occlusal plane

Search document

Case sensitive  Whole word

When you click on the page symbol, the thumbnail page view is displayed.

This allows you to change the page view.

This allows text content to be copied directly from the PDF. Mark the desired text.

The magnifying glass can be used to search for terms within the PDF.

16

# Document Viewer Properties 2

VITA Media database Contact & support Change password English Logout

---

112% [-] [0] [1] [2] [3]

Page Transition

- Continuous Page
- Page by Page

Page Orientation

- Rotate Clockwise
- Rotate Counterclockwise

Page Layout

- Single Page
- Double Page
- Cover Facing Page

VITA CAD-TEMP monoColor and VITA CAD-TEMP multiColor consists of a unique fiber free, homogeneous, high molecular and cross linked acrylate polymer with microparticle filler, or MIP material.

With the MIP material (Microfiller Reinforced Polyacrylic) developed by VITA, inorganic microparticles are polymerized into the network, and a homogeneous material with high abrasion resistance is created using the VITA pressing process.

**Physical properties**

Properties	Unit	Value*
Flexural strength	MPa (N/mm <sup>2</sup> )	>80
Modulus	MPa (N/mm <sup>2</sup> )	approx. 2800
Soltering temperature (DSC)	°C	approx. 110
Inorganic filler content	Wt%	approx. 14
Water absorption	complies with EN ISO 10477 Polymer based crown and bridge materials	
Solubility	complies with EN ISO 10477 Polymer based crown and bridge materials	
Shade stability	complies with EN ISO 27117 Artificial teeth for dental prostheses	

\* The technical/physical values are typical measuring results and refer to internal samples and measurement equipment available on site. If samples are prepared using different methods and measurement equipment, other measuring results may be produced.

**Patient target group**  
No restrictions

**Intended user**  
Dental professionals only; dentist and dental technician (Rx only).

**Indication and processing requirements**  
VITA CAD-Temp is used for the fabrication of multi unit, fully or partially anatomical long term temporary bridge restorations with a span of up to two pontics and a clinical wearing period of up to three years. For CAD/CAM system requirements, please refer to the information provided by the manufacturer of the respective system.

Indication	Anterior crown	Posterior crown	Anterior bridge*	Posterior bridge*
VITA CAD-Temp	●	●	●	●

● recommended \* Only temporary bridges are recommended for wearing periods of more than six months.

**Contraindication**  
Permanent restorations with a clinical wearing period of more than three years. In patients who are allergic to PMMA.

Search document

Case sensitive

- Full screen
- Download
- Print
- Dark mode
- Language

This opens the Page view menu.

Dragging the area for the thumbnail side view.

A download can also be started here by clicking on the Settings icon.

# Contact

# VITA

## Media requests and contact

VITA Zahnfabrik

H. Rauter GmbH & Co. KG

Ina Bretschneider

E-Mail: [i.bretschneider@vita-zahnfabrik.com](mailto:i.bretschneider@vita-zahnfabrik.com)

T: +49 (0) 7761 / 562-502

## Technical support

it.x informationssysteme gmbh

Customer Support

E-Mail: [support@itx.de](mailto:support@itx.de)

T: +49 (0) 75 31 / 89 27 300

F: +49 (0) 75 31 / 89 27 329

VITA Zahnfabrik H. Rauter GmbH & Co. KG

Spitalgasse 3

D-79713 Bad Säckingen

Germany



<https://vita-zahnfabrik.com>



FACEBOOK Follow us



INSTAGRAM Follow us